

PM STEPPING MOTOR TYPE 20PM20M01-01B

General specifications		Electrical specifications		Wiring Diagram	
Step Angle	18°	Rated voltage	5 V		
Phase	2	Resistance per phase	10 ohm±10%		
Insulation Class	B	Rated Current	0.5 Amp		
Insulation resistance	50Mohm MIN(500V DC)	Inductance	3.7mH±20%		
Temperature raise	60°C max	Pull in frequency	520 pps Min.		
		Holding Torque	50 g.cm		
		Detent torque	8 g.cm		

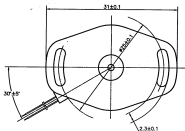
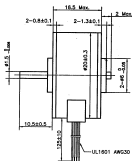

detail of excited model:
from the shaft reach out side ccw

COLOR	STEP	1	2	3	4
RED	A	+	-	-	+
YELLOW	B	+	+	-	-
WHIT	C	-	+	+	-
BLUE	D	-	-	+	+

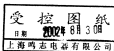

comment:
Holding Torque Testing Conditions
constant current driver
two phase on
phase current 0.5Amp

A					STANDARD	2002.8.30
					APPROVE	2002.8.30
REV. NO.	MAX. QTY.	CR.NO.	DESIGN			